



# 200 & 400

What to specify...

1. Model

2. Voltage

3. Volume or Vacuum

4. Pre-filter

5. Main filter

6. Connection Kit

7. Interfacing Kit

	200		400	
<b>1</b>				
<b>2</b>				
<b>3</b>				
<b>Voltage</b>	<b>230V ±10%</b>	<b>120V ±10%</b>	<b>230V ±10%</b>	<b>120V ±10%</b>
<b>Part number (Volume Control)</b>	<b>0LX2100D</b>	<b>0LX2101D</b>	<b>0LX4000D</b>	<b>0LX4001D</b>
<b>Part number (Vacuum Control)</b>	<b>080026D</b>	<b>081026D</b>	<b>080410D</b>	<b>080411D</b>
<b>Wattage</b>	0.45 kW	0.45 kW	1.2 kW	1.1 kW
<b>Frequency</b>	50Hz / 60 Hz	50Hz / 60 Hz	50Hz / 60 Hz	50Hz / 60 Hz
<b>Cabinet height (inc castors)</b>	710 mm	710 mm	710 mm	710 mm
<b>Cabinet width (not inc hose)</b>	445 mm	445 mm	445 mm	445 mm
<b>Cabinet depth (not inc hose)</b>	528 mm	528 mm	528 mm	528 mm
<b>Cabinet weight</b>	50 Kg	50 Kg	50 Kg	50 Kg

**4** **Pre-filter Pad** **FREE**



**Options:** Pack of 4  
**Code:** 202260

**5** **Main filter** **FREE**



**Options:** HEPA/Chemical (std) 113505  
HEPA/Twin Chemical 113579  
HEPA/Chemical Cleanroom 113512  
Chemical 113508  
HEPA/CSA 113662  
Pleated Bag 113531  
Solvent Lock\* 113513

**Code:**

**\* IMPORTANT!**  
Must be specified for CIJ printing applications.



**6** **Connection Hose Kit** **FREE**

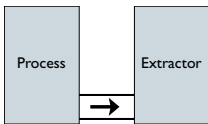

Connect to Lasers **PAGE35**  
Connect to Pipework/Machinery **PAGE37**  
Connect to Soldering Irons **PAGE39**  
Connect to CIJ printers\* **PAGE37**  
(\*Note CIJ connection kits are not included in the machine price)

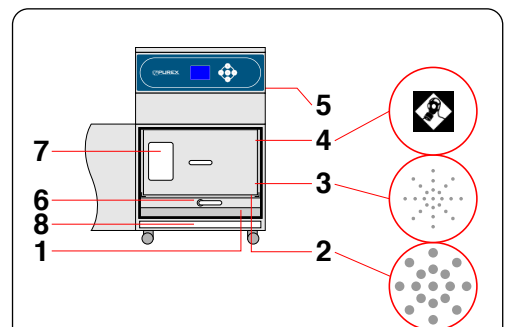

**Legend:**

- 1) Air inlet.
- 2) Pre-filter.
- 3) Main Filter (HEPA location). †
- 4) Main Filter (Carbon location). †
- 5) Clean air returned to workplace.
- 6) Filter locking handle.
- 7) Filter identification label.

All machines are mounted on four castors for increased mobility.

† Standard Filter Only

**7** **Machine Interfacing Kit (Optional)**

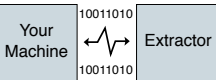

**Start/Stop Control:** Extraction unit starts/stops when a connected piece of equipment is switched ON/OFF.

**Filter Blocked Warning:** A signal is sent to a connected piece of equipment to trigger an alert or to shut it down.

Allows the Purex system to interface with a piece of equipment connected to it.

See **PAGE 40**

## Digital Control System

A dedicated control, monitoring and display system unique to Purex fume extractors. All functions are fully automatic, all the user has to do is set the appropriate airflow on installation. The features of this system are designed to:

- Lower energy consumption by using variable speed motors and automatic flow control.
- Increase filter life by using the optimal extraction rate.
- Further protect people by constantly monitoring exhaust emissions.
- Interface with other equipment e.g. a laser.
- Maintain a constant extraction rate to prevent fume escape or damage to equipment.

## System Features...

- Automatic electronic flow control - maintains a constant extraction rate even as the filter blocks
- Adjustable airflow
- Clear and informative graphic display
- Gas and Particle Sensors on the exhaust
- Low capital and running costs
- Quick change pre-filters deliver longer filter life
- Submicronic (HEPA) filtration removes 99.997% of particles down to 0.3 microns
- Activated carbon filtration removes harmful gas
- Simple to install and quiet in operation
- Easy to relocate
- Precision made from stainless steel

## # Supplied free with every machine purchase

- 1 x Main filter
- 4 x Pre-filter pads
- 1 x Connection Kit (except CIJ kit)
- 1 x Power cable (see pg41)

## Accessories

Please see the accessories section at the back of this brochure.